



中国认可
国际互认
检测
TESTING
CNAS L0273

FOXCONN CHINA MEASUREMENT CENTER

Test Report

Client: Shenzhen Chainway Information Technology Co.,Ltd

Add. of Client: 9/F, Building 2, Daqian Industrial Park, Longchang Rd.,
District 67, Bao'an ,Shenzhen

Description: Mobile Data Terminal

Model/Type: H100

Date of Receipt: 2017-09-9

Date of Test: 2017-09-9

Approved by: *Hu Juan*

Inspected by: *Hu Juan*

Reported by: *Xiangcai Qm*

Date of Report: 2017-09-09

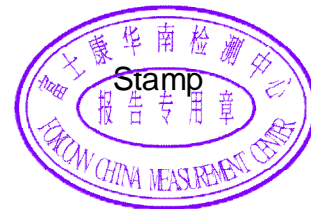

Code: FM8Y8M

Company: Futaihua Industry (Shenzhen) Co., Ltd. South China Measurement Center (Foxconn CMC)

Add:106#, No.2, 2nd Donghuan Road, 10th Yousong Industrial District, Longhua, Shenzhen, Guangdong, China

(Zip Code:518109)

Tel.:400-845-2188

Fax. :0755-27706168-61920

Complaint Tel. : 0755-27706168-63704

E-mail: hzlh-cmc-qa@foxconn.com



中国认可
国际互认
检测
TESTING
CNAS L0273

FOXCONN CHINA MEASUREMENT CENTER

Results of Test

1. 2Test item:

- I Drop Test

2. Product information:

- I Quantity: 1PCS

3. Laboratory Environment:

- I Temperature: (25±10)°C
- I RH: (25~85)%

4. Test Equipment:

Equipment	Drop Tester
Manufacturer	YOSHIDA
Model/Type	DT-202
Controlled Number	99Q-0013
Due Cal. Date	2018-05-08

5. Test Condition:

Refer to the test specification which is provided by applicant department.

- I Drop height: 1.5m.
- I Drop plate: marble
- I Drop sequence :
 - I 1. A flat drop on the rear side
 - I 2. A flat drop on the left side
 - I 3. A flat drop on the right side
 - I 4. A flat drop on the top side
 - I 5. A flat drop on the bottom side
 - I 6. A flat drop on the front side
 - I 7. Repeat procedure 1-6 for 3 times
 - I 8. A flat drop on the left side for 1 time
 - I 9. A flat drop on the right side for 1 time

6. TEST PROCEDURE:

- I Refer to IEC 60068-2-31 (2008).
- I The photos of sample are shown as below:



中国认可
国际互认
检测
TESTING
CNAS L0273

FOXCONN CHINA MEASUREMENT CENTER

Results of Test

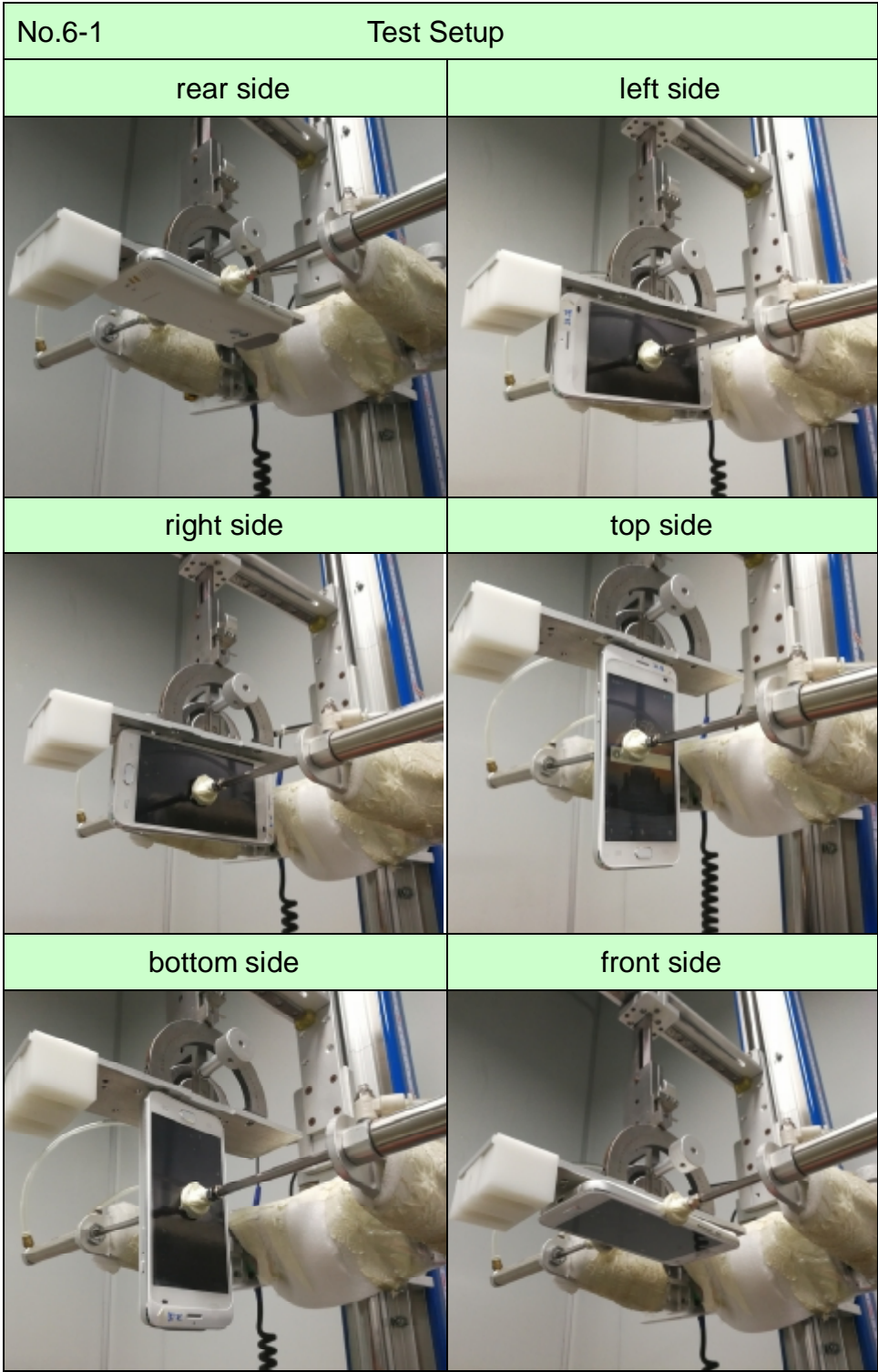



中国认可
国际互认
检测
TESTING
CNAS L0273

FOXCONN CHINA MEASUREMENT CENTER Results of Test

7. Test Result:

No.	Test part	Test Symptom		
		1cycle	2cycle	3cycle
LHJ1700880_1-01#	Rear	No damage	No damage	No damage
	Left	Left surface appeared fall marks	Left surface shell separate	Left surface shell separate severe
	Right	Right surface appeared fall marks minor	Right surface shell separate	Right surface shell separate severe
	Top	Top surface appeared fall marks and bottom surface shell separate	Top right corner appeared fall marks	No damage
	Bottom	No damage	Bottom shell separate	Bottom surface appeared fall marks
	Front	No damage	No damage	No damage
	Left	/	/	Left surface shell separate severe
	Right	/	/	Right surface appeared fall marks severe
	After the test ,sample can function correctly			



中国认可
国际互认
检测
TESTING
CNAS L0273

FOXCONN CHINA MEASUREMENT CENTER

Results of Test

8. Test Photo:

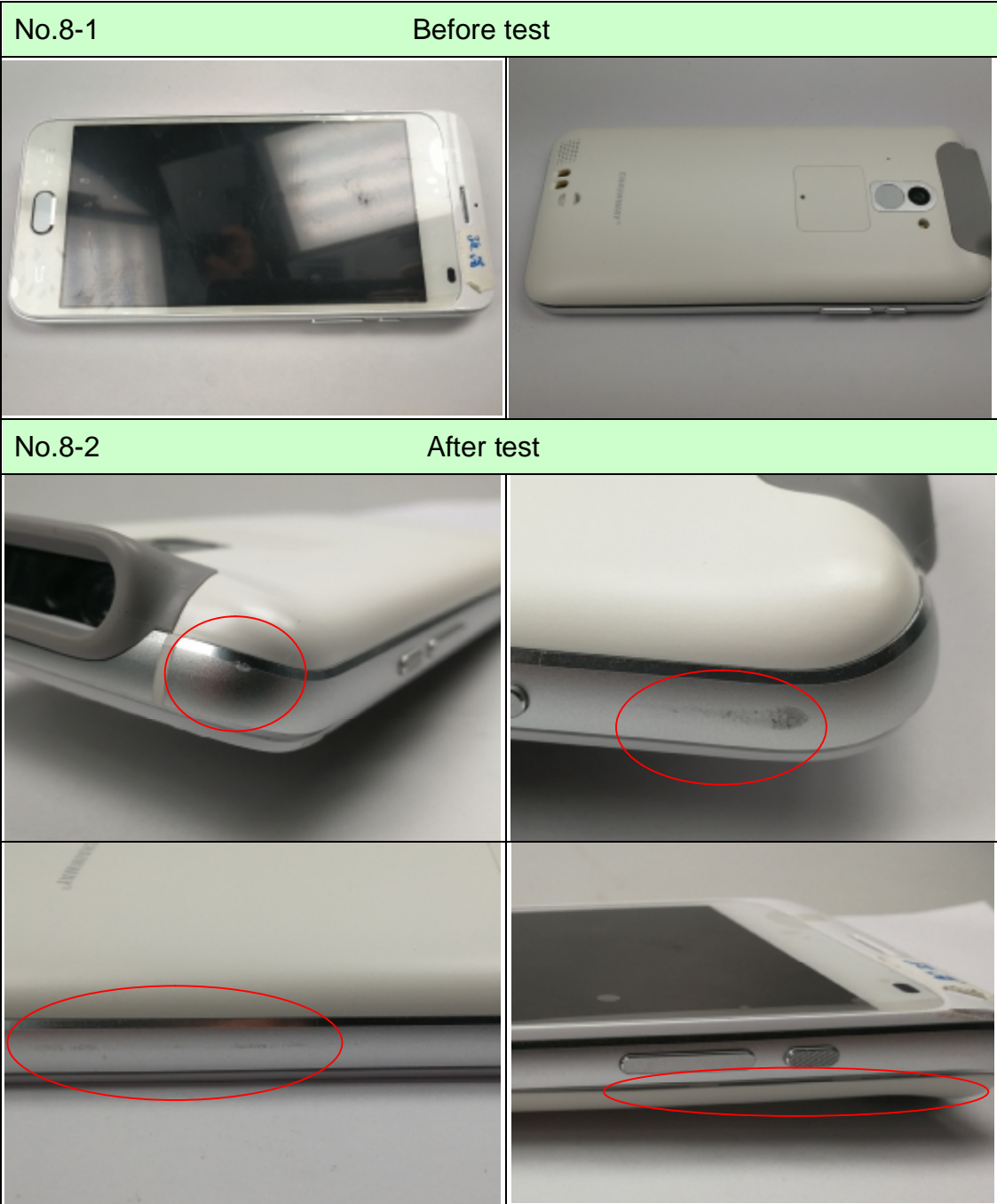

FOXCONN CHINA MEASUREMENT CENTER

Results of Test

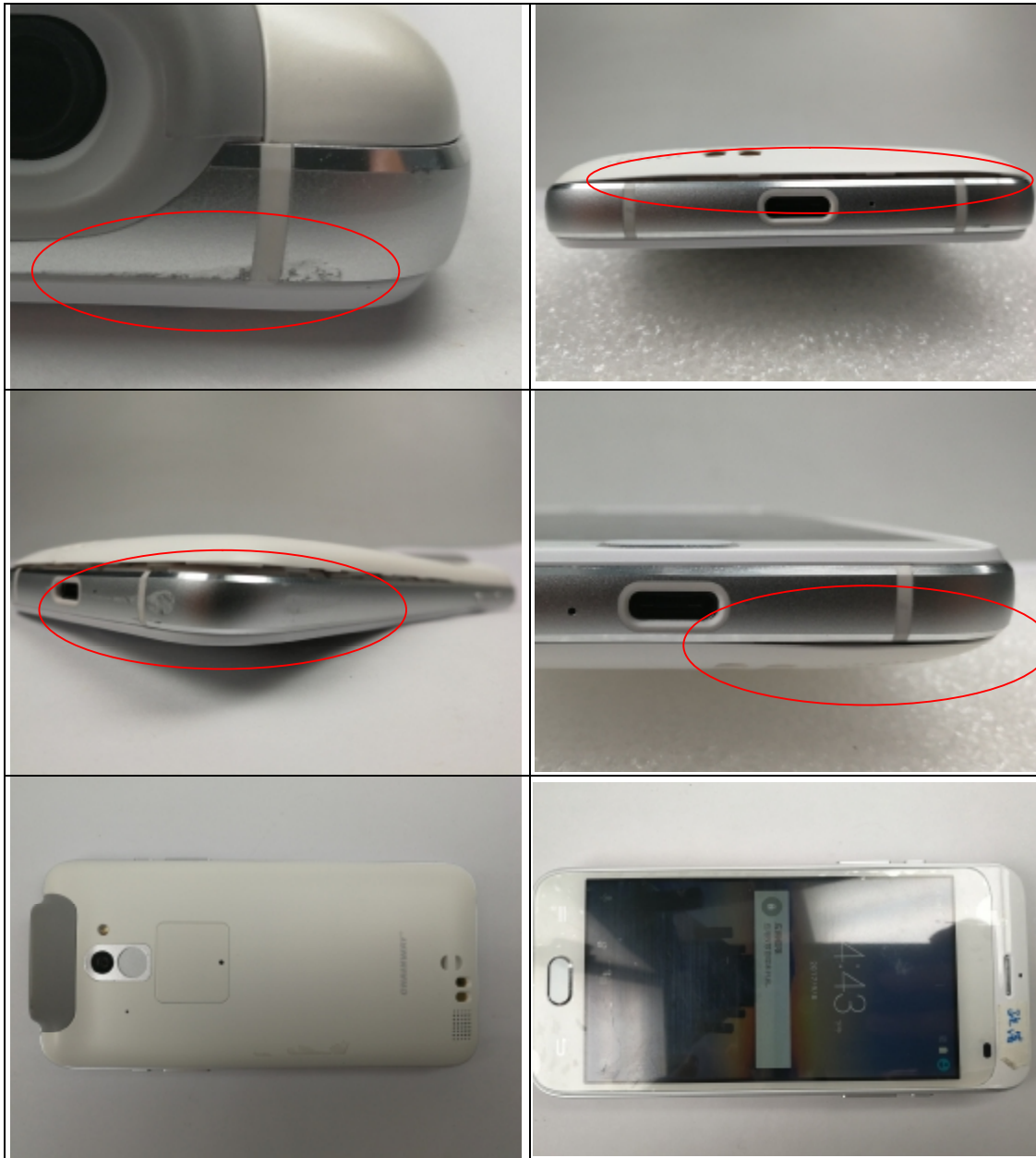

— END —

Notes:

1. This laboratory is accredited by China National Accreditation Service for Conformity Assessment under Laboratory Accreditation Certification No. CNAS L0273.
2. All data issued by this laboratory are traceable to International System of Units(SI).
3. The results relate only to the items tested.
4. The Sample and sample information provided by customer.
5. This report shall not be duplicated partially except with the written approval of the our laboratory.